

# Wire Rope Suspension Solutions

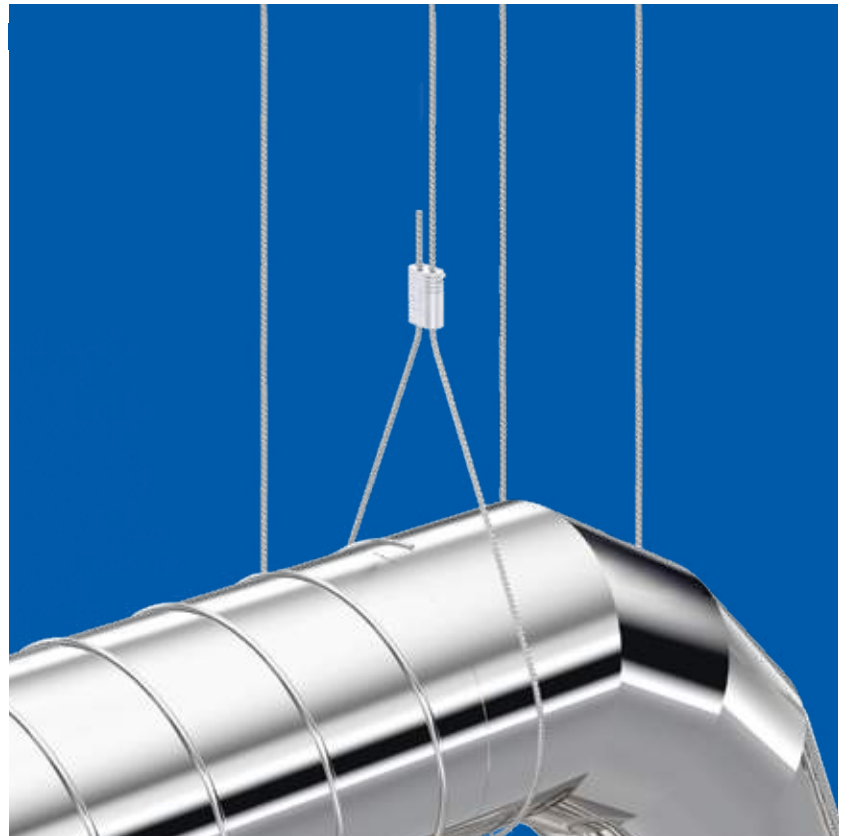

[www.goldenpeacock.com](http://www.goldenpeacock.com)



CERTIFICATIONS.....	03
WIRE ROPE SUSPENSION SOLUTIONS.....	04-05
SUSPENSION SYSTEM .....	06
LOOP GRIPPERS.....	07-08
HEXA GRIPPERS.....	09 - 11
CATENARY HANGER SYSTEM.....	12-13
<div>GPWS ATTACHMENTS</div>	
FERRULE LOOP.....	14
STUD.....	15
SNAP HOOK.....	16
EYEBOLT.....	17
SWIVEL EYELET.....	18
WIRE ROPE.....	19

# Certifications



**CERTIFICATE OF COMPLIANCE**

Certificate Number: UL-CA-2146728-0  
Report Reference: E513046-20211112  
Date: 9-Dec-2021

Issued to: GOLDEN PEACOCK OVERSEAS LTD  
Plot 20-A  
Nepz Noida, Uttar Pradesh  
India 201305

This is to certify that representative samples of DWMU7 - Conduit and Cable Hardware Certified for Canada  
See Addendum Page for Product Designation(s).

Have been investigated by UL in accordance with the Standard(s) indicated on this Certificate.

Standard(s) for Safety: CSA C22.2 NO. 18.4-15, 2nd Ed., Issue Date: 2015-02-01, Revision Date: 2019-03-22

Additional Information: See the UL Online Certifications Directory at <https://q.ulprospector.com> for additional information

This Certificate of Compliance does not provide authorization to apply the UL Mark. Only the UL Follow-Up Services Procedure provides authorization to apply the UL Mark.

Only those products bearing the UL Mark should be considered as being UL Certified and covered under UL's Follow-Up Services.

Look for the UL Certification Mark on the product.



**CERTIFICATE OF COMPLIANCE**

Certificate Number: UL-US-2155524-0  
Report Reference: E513046-20211112  
Date: 9-Dec-2021

Issued to: GOLDEN PEACOCK OVERSEAS LTD  
Plot 20-A  
Nepz Noida, Uttar Pradesh  
India 201305

This is to certify that representative samples of DWMU - Conduit and Cable Hardware  
See Addendum Page for Product Designation(s).

Have been investigated by UL in accordance with the Standard(s) indicated on this Certificate.

Standard(s) for Safety: UL 2239, 2nd Ed., Issue Date: 2015-02-20, Revision Date: 2019-03-22

Additional Information: See the UL Online Certifications Directory at <https://q.ulprospector.com> for additional information

This Certificate of Compliance does not provide authorization to apply the UL Mark. Only the UL Follow-Up Services Procedure provides authorization to apply the UL Mark.

Only those products bearing the UL Mark should be considered as being UL Certified and covered under UL's Follow-Up Services.

Look for the UL Certification Mark on the product.



**WITNESS TEST REPORT**

  
TUV NORD PRIVATE LIMITED  
Angar Palladium, 201 & 204,  
Surya He-1061,  
Durgam Cheruvu,  
Baker Road, Bangalore,  
Karnataka 560025, India  
Tel: +91 80 67113119  
Fax: +91 80 67113119  
Email: [nord@tuv-nord.com](mailto:nord@tuv-nord.com)  
Website: [www.tuv-nord.com](http://www.tuv-nord.com)

Test Report No.:	TUVNORD/MSR/17-180001-1	Page 1 of 8
Manufacturer Name & Address	Golden Peacock Overseas Ltd, 20A, NSEZ, Noida, Uttar Pradesh 201305	
EUT Description	GPI Wire Suspension Kit	
Trademark	   Serial No.: ---	
Sample No.	A) GPI Cable Bracket 2PCS 30x, 90° Threaded Steel Coupled with 1 Iron MS Q235 Standard Wire, MS Endhook, MS Flush Anchors B) GPI Cable Bracket 2PCS 30x, 90° Threaded Steel Coupled with 1 Iron MS Q235 Standard Wire, MS Endhook, MS Flush Anchors C) GPI Cable Bracket 2PCS 30x, 90° Threaded Steel Coupled with 1 Iron MS Q235 Standard Wire, MS Endhook, MS Flush Anchors D) GPI Cable Bracket 2PCS 30x, 90° Threaded Steel Coupled with 1 Iron MS Q235 Standard Wire, MS Endhook, MS Flush Anchors E) GPI Cable Bracket 2PCS 30x, 90° Threaded Steel Coupled with 1 Iron MS Q235 Standard Wire, MS Endhook, MS Flush Anchors F) GPI Cable Bracket 2PCS 30x, 90° Threaded Steel Coupled with 1 Iron MS Q235 Standard Wire, MS Endhook, MS Flush Anchors G) GPI Cable Bracket 2PCS 30x, 90° Threaded Steel Coupled with 1 Iron MS Q235 Standard Wire, MS Endhook, MS Flush Anchors H) GPI Cable Bracket 2PCS 30x, 90° Threaded Steel Coupled with 1 Iron MS Q235 Standard Wire, MS Endhook, MS Flush Anchors I) GPI Cable Bracket 2PCS 30x, 90° Threaded Steel Coupled with 1 Iron MS Q235 Standard Wire, MS Endhook, MS Flush Anchors J) GPI Cable Bracket 2PCS 30x, 90° Threaded Steel Coupled with 1 Iron MS Q235 Standard Wire, MS Endhook, MS Flush Anchors	
Date of receipt	02/03/2018	
Condition of sample on receipt	Good	
Witnessing Laboratory Location with Address	Golden Peacock Overseas Ltd, 20A, NSEZ, Noida, Uttar Pradesh 201305	
Witnessing Agency Name & Address	TUV India Pvt Ltd 1st Floor, 20/201, B-3, Sector 7, Noida, Uttar Pradesh 110006	
Test specification	ANSI/MACHA (09-2006) and Custom Specification	
Test Result	Pass (See page no. 2)	
Other Aspects	The Report consists of 8 pages including this cover page.	
This test report relates to the test sample submitted and list of documents attached.		
Witnessed & Prepared by:	Approved by:	Issued by:
		
Name: Anshul Bhadani Designation: Engineer	Name: Manish Bhatnagar Designation: Head Lab Operation	Name: Swagat Shrivastava Designation: Officer-Customer Relations
Date: 24.03.2018	Date: 27/03/2018	Date: 24.03.2018

Registered & Head Office: 201, Sakya Plaza - I, L.B.S. Marg, Gurgaon (Haryana), India 122002  
Phone: (012) 4047 7000 • Fax: (012) 4047 7000 • E-mail: [nord@tuv-nord.com](mailto:nord@tuv-nord.com) • Website: [www.tuv-nord.com](http://www.tuv-nord.com)  
TUV NORD INDIA

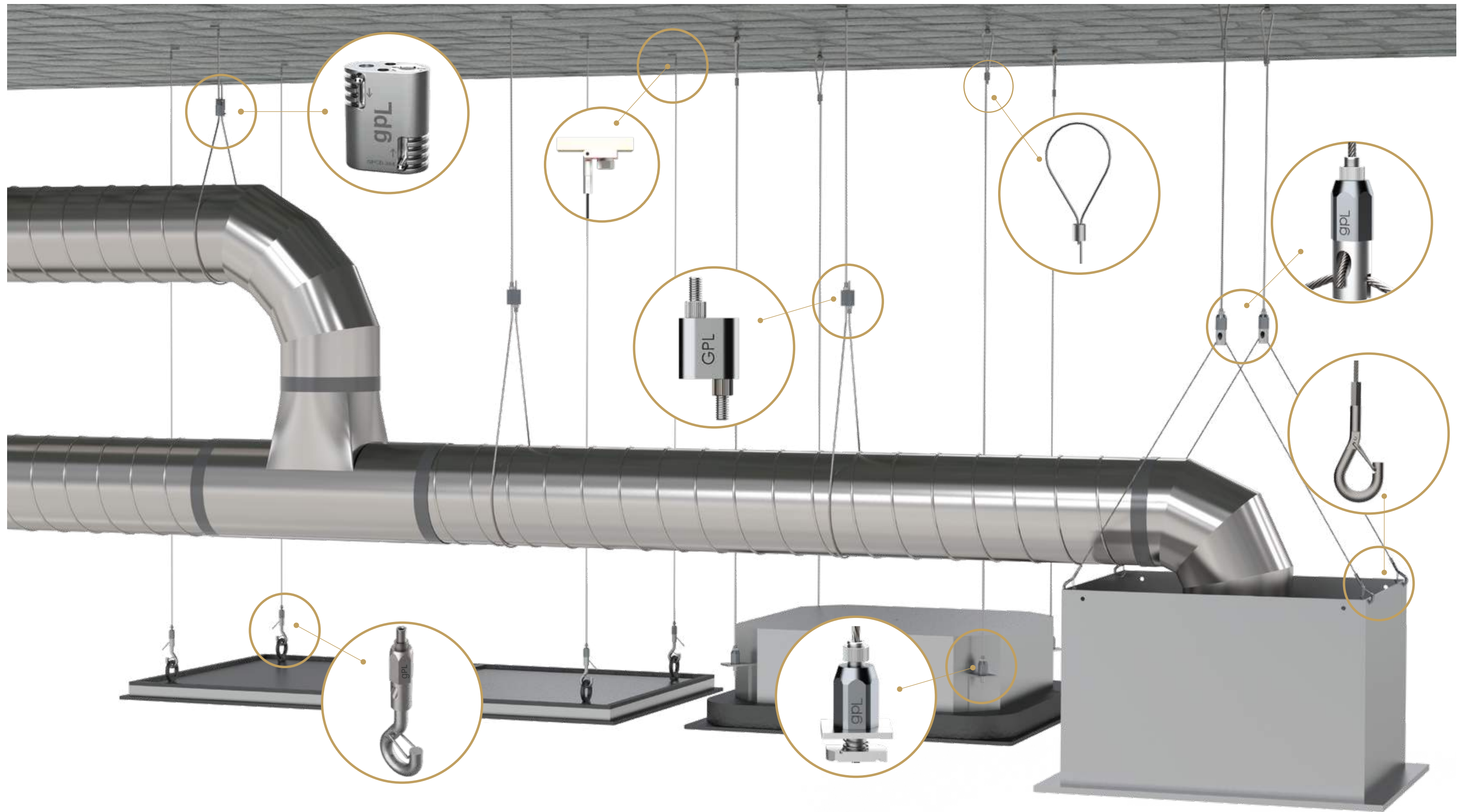

# WIRE ROPE SUSPENSION SOLUTIONS



Golden Peacock is one of the world's leading manufacturer of wire rope suspension solutions. We offer complete solutions to suspend static load by offering 3 ball and 6 ball bearing locking mechanism in different materials along with wire ropes in various thicknesses and end attachments.

Golden Peacock Wire rope suspension (GPWS) is increasingly being used for mounting building services components in commercial, public sector and industrial buildings. GPWS is safe and reliable solution and is tested independently by TUV, UL and comply with SMACNA standards.

There are major advantages of flexible positioning and installation productivity benefits compared to traditional systems. GPWS helps adopting eco-friendly approach by drastically reducing the steel consumption & reducing carbon footprints due to ease of logistics.

GPWS can be used to support a very wide range of loads and objects. Almost any piece of building services equipment could be suspended using wire ropes, such as:

- Pipework
- Ductwork
- Cable trays
- Ceiling grids
- Luminaires and lighting systems
- Large signs and indicator display
- Decorative objects
- Fan coils and air handling units

## Advantages of GPWS

- Aesthetically pleasing and light weight products.
- Easy to adjust without special tools, making it hassle free installation.
- Faster to install compared to threaded rods, save time and money.
- Less storage space required.
- Easy to handle & transport at site.
- Can easily be installed at an angle, serves multiple applications.
- Offers 5:1 safety feature for vertical plane.
- Offers different sizes to carry specific weight range for different applications.
- Optional locknuts are available for superior safety to avoid damage due to accidental movement/ seismic vibration.

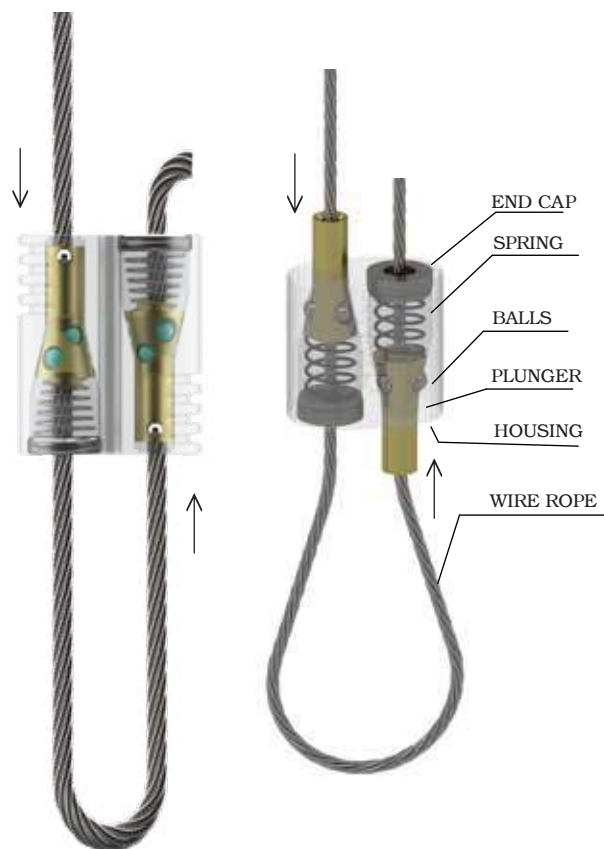

## Gripper

A Gripper is a sophisticated piece of hardware that allows the user to adjust the height of a fixture without utilizing tools. As a cable slides through the gripper, a plunger and three balls within the gripper surround the outside diameter and catch the cable as it passes through the gripper. When mounted and weight is applied to the gripper, the tension forces the balls to grab the cable in a pinching movement.

The use of six balls offer maximum safe working load by gripping the wire at six points. Balls have the advantage of rolling instead of sliding which makes it easier for the mechanism to grip the wire. It is a limitation of serrated wedge grippers that the wedge needs to slide under high loads and can sometimes stick in the passage of the gripper and it becomes difficult to release the wedge through its actuating pin, by hand, in order to release the cable.

# Loop Grippers



GPWS loop grippers are unique ball-bearing, tool less wire gripping devices. These are available in different sizes and all of them are designed specifically for suspending different loads for variety of applications.

GPWS introduced Aluminium loop gripper which are one of the most environment friendly metal because of its sustainability. As the most recyclable industrial material, aluminium can be recycled infinitely to produce the same product without degrading its inherent value. Recycling aluminium also saves 95% of the energy used in its production from raw materials.



**Minimum breaking load 1500 Kg**

( All size come with a 5:1 Safety factor )

## Technical Information ( Load Ratings )

Product Code	Wire Range	Safety Factor	Safe Working Load (Kg)
GPCB - 436	1.5 mm	5:1	Up to 30
GPCB - 437	2.0 mm	5:1	Up to 56
GPCB - 382	2.0 mm	5:1	Up to 56
GPCB - 438	3.2 mm	5:1	Up to 113
GPCB - 383	3.2 mm	5:1	Up to 113
GPCB - 439	5.0 mm	5:1	Up to 300
GPCB - 384	5.0 mm	5:1	Up to 300
GPCB - 385	6.0 mm	5:1	Up to 400

## S.S Loop Grippers



Product	GPCB - 305C	GPCB - 424	GPCB - 425
Wire Dia	1.5 mm	2.0 mm	3.2 mm
Safety Factor	5:1	5:1	5:1
Safe Working Load (Kg)	Up to 30	Up to 56	Up to 90

### Function:

Recommended for Suspension of HVAC electrical & mechanical services ( for outdoor installation).

### Applications:

Suitable for use in oil field, swimming pools, where high fire ratings and rust free products are required.

### Technical Data:

All products carry 5:1 safety factor.

### Material Specification

**Gripper:** Stainless Steel

**Wire rope:** Stainless Steel

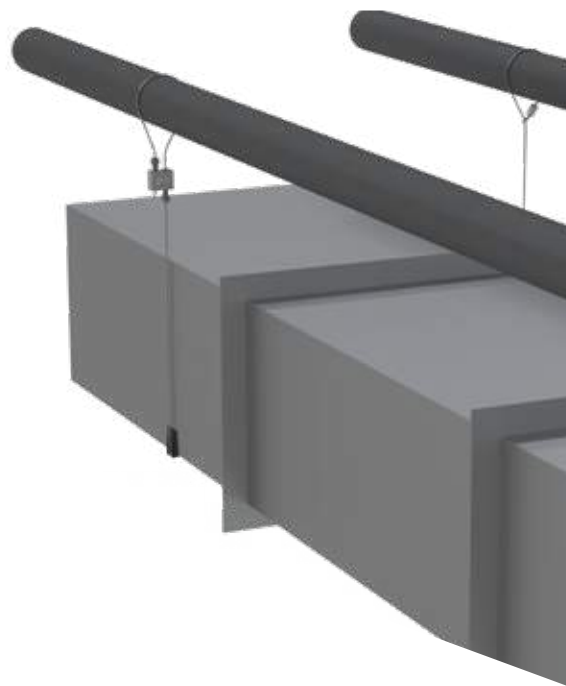

## How Loop Gripper Works

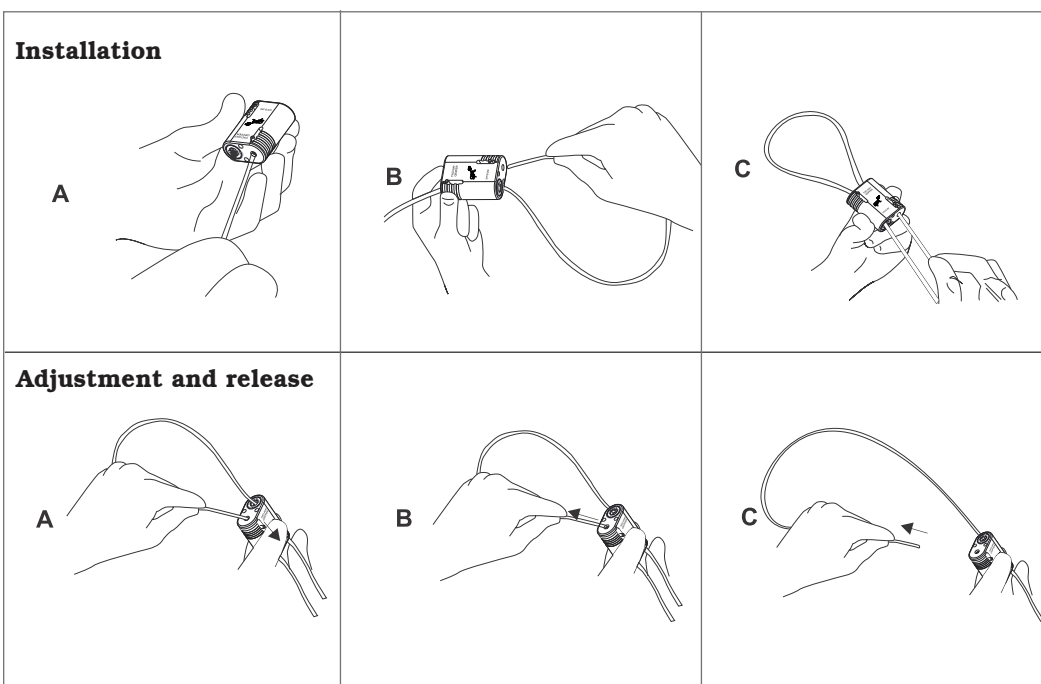

### Description:

The GPL Hexa gripper assembly stands as a rapid and reliable solution for efficiently placing Strut in single or multi-tiered setups, catering to both HVAC and cable management requirements. Tailored to support the suspension of rectangular ducts, cable trays, unit heaters, and more, it offers a flexible approach.

Installation is made more convenient by the option to pre-install the assembly into the strut channel at ground level, minimizing high-altitude work time. Additionally, its threaded piston streamlines height adjustments, ensuring a timesaving benefit.

### Ideal for below applications but are not limited to:

1. Electrical
2. HVAC & Mechanical
3. Single-tier cable tray suspension
4. Multi-tier cable tray suspension

### Features:

1. GPL Hexa grippers are made up of aluminum material which is a lightweight & strong structural material.
2. Versatile – GPL hexa range can be used with different applications.
3. Safe, durable, quick & easy to install.
4. Comes with a lock nut for extra safety.
5. Can be used with single or multi-tier applications.
6. Ideal for static loads
7. Safety factor – 5:1 ratio





## Hexa Gripper Product Range



### Hexa Gripper Details

Series Code	Wire Size	Bottom Exit	Bottom Exit with Loop	Bottom Exit with Channel Nut	Side Exit with Y-FIT	Side Exit with tail	Side Exit with Hook
GPCB - 394	2.00 mm	✓	✓	✓	✓	✓	✓
GPCB - 394	2.40 mm	✓	✓	✓	✓	✓	✓
GPCB - 420	3.20 mm	✓	✓	✓	✓	✓	✓

# Hexa Gripper Overview



## Wire Detail and Breaking Strength

WIRE DIAMETER	SERIES CODE	WIRE CONSTRUCTION	WIRE MATERIAL	SAFE WORKING LOAD OF WIRE	BREAKING LOAD OF WIRE
2.0mm/5-64inch	GPCB - 394	7x7	Galvanized Steel	40kg/ 88lbs	225kg/495lbs
2.4mm/3-32inch	GPCB - 394	7x7	Galvanized Steel	50kg/110lbs	300kg/660lbs
3.2mm/1-8inch	GPCB - 420	7x7	Galvanized Steel	100kg/220lbs	500kg/1100lbs

Note: The correct gripper and wire rope combination should be used to ensure desired minimum safe working loads.

## Hexa gripper assembly

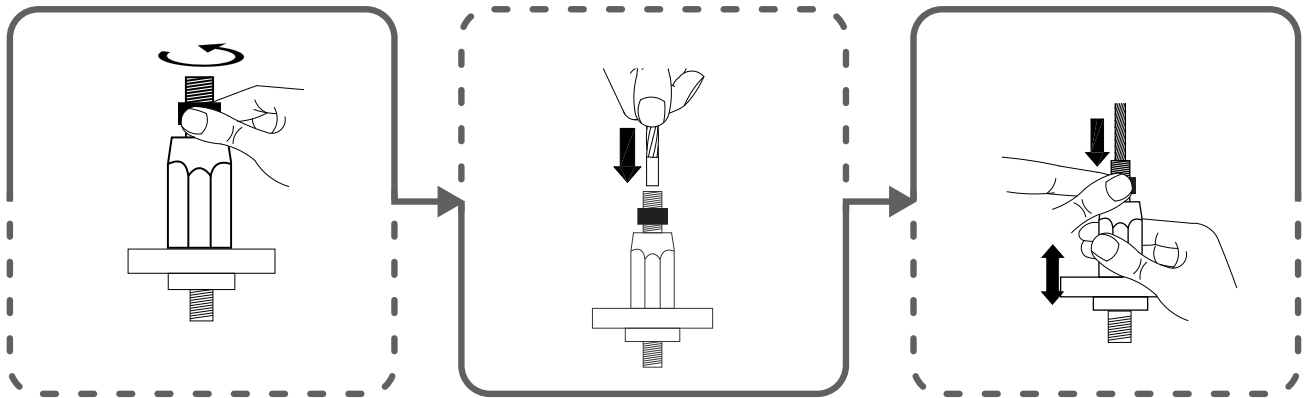

First, the knurled cap is unscrewed, so the wire can be inserted

Once the holder put in place the cap is screwed down until firm resistance is felt this pulls the cable into the cone

Vertical re-adjustment of the holder follows the same procedure

### Warnings:

- Use only GPL specified wire construction to get the desired result.
- Do not exceed the safe working load of the product.
- Do not use covered / insulated cable.
- Do not apply paint or other coating.
- Do not apply lubricant.
- This product is not recommended for lifting loads.
- Remove damaged cable end prior to inserting into the gripper.
- Do not use in chlorinated atmospheres.
- Recommended for use in dry locations only.
- Recommended for static load applications only.



The GPL Catenary hanger is a specialized component which is ideal for use in settings without accessible overhead mounting options. This system is commonly employed in HVAC, MEP other Heavy-duty fixtures.

## Features:

1. Easy & faster to install.
2. Multifunctional application for HVAC, MEP, Lighting fixtures etc.
3. Easy to carry on site.
4. Robust build.
5. Aesthetically pleasing.
6. Designed for scenarios where there are no overhead anchor points.
7. GPL catenary hanger can use with three different wire dia. 4.0, 5.0, 6.35mm.

Model-no.	Material	SWL Per Free span	SWL for bottom wire
GPA-151	Aluminium	4.0mm wire - 40kg max.	1.5mm wire - 30kg max.
		5.0mm wire - 70kg max.	2.0mm wire - 56kg max.
		6.35mm wire - 100kg max.	3.0mm wire - 100kg max.

\* Safety factory - 5:1

Special engineering grade casted material provides high strength and consistent quality. Hook is the main part of hanging & horizontal adjustment.

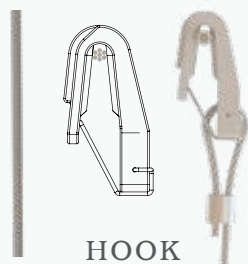

HOOK

Special engineering grade spring system, it bounds the hanger to come out from horizontal tensioned wire.

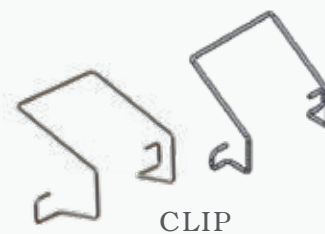

CLIP

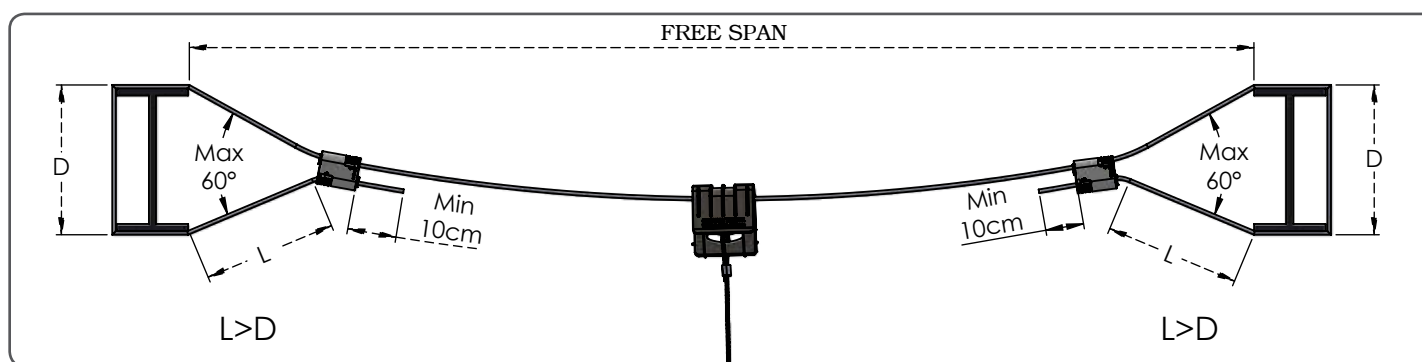

## Warnings

- Do not use any tensioning tool.
- Use only gpl specified or supplied wire along with gpl catenary hanger.
- Do not exceed the safe working load of the product.
- Do not apply paint or other coating on wire.
- Do not apply lubricant.
- Do not use wire with fray.
- Do not use in chlorinated atmospheres.
- Recommended for use in dry locations only.

## Wire ropes & it's end accessories with application



### Ferrule Loop

Wire rope crimped with ferrule for loop making



#### Function:

Recommended for the suspension of HVAC, electrical and mechanical services

#### Applications:

Purlins, Beams, Roof, Trusses and other accessible building features

#### Technical Data:

- SMACNA compliance - all products carry a 5:1 safety factor
- As per UL 1598, & 2239 CSA C22.2 No.250.0-08
- Tested & Certified by TUV Nord.

#### Material Specification

**Ferrule** Aluminium

### Installation

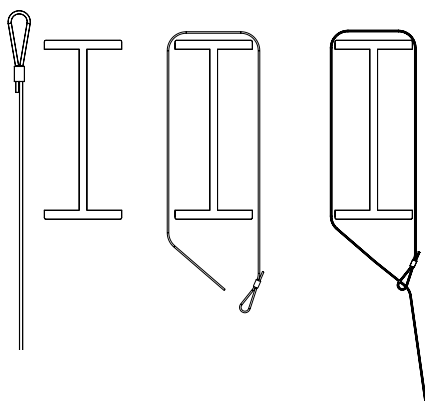

### Application



Wire Diameter	1.5 mm	2 mm	3.2 mm	5 mm
Safety Factor	5:1	5:1	5:1	5:1
Safe Working Load (Kg)	Up to 30	Up to 56	Up to 113	Up to 300

**Note:** The correct gripper and wire rope combination should be used to ensure desired minimum safe working loads.



## Stud

Wire rope crimped with M6,M8 and M10 stud



## Y-fit Stud

Wire rope crimped with ferrule and M6,M8 and M10 stud

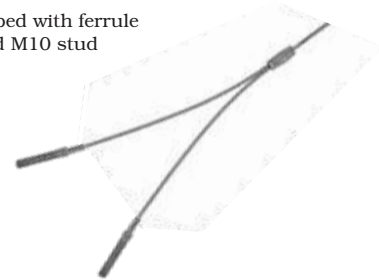

### Function:

Recommended for the suspension of HVAC, electrical and mechanical services (For indoor & stationary setting).

### Applications:

Concerte ceilings, metal decking and pressed metal brackets (with nuts)

### Technical Data:

- SMACNA compliance - all products carry a 5:1 safety factor
- As per UL 1598, & 2239 CSA C22.2 No.250.0-08
- Tested & Certified by TUV Nord.

### Material Specification

<b>Stud</b>	Steel
<b>Wire rope</b>	Steel Galvaized
<b>Ferrule</b>	Aluminium

## Installation

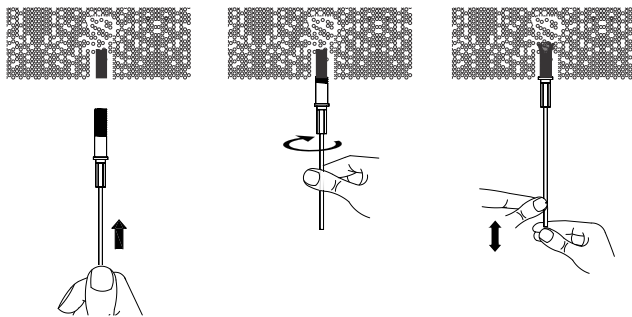

## Application

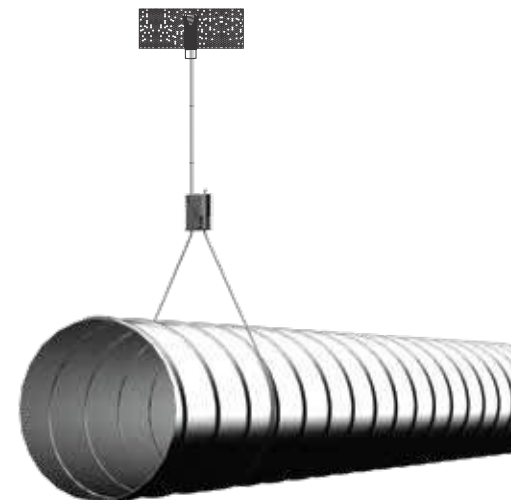

Thread	M6	M8	M8	M10
Wire Diameter	1.5 mm	2 mm	3.2 mm	5 mm
Safety Factor	5:1	5:1	5:1	5:1
Safe Working Load (Kg)	Up to 30	Up to 56	Up to 113	Up to 300

**Note:** The correct gripper and wire rope combination should be used to ensure desired minimum safe working loads.

## Snaphook

Wire rope crimped with snaphook



## Y-fit Snaphook

Wire rope crimped with snaphooks



### Function:

Recommended for the suspension of HVAC, electrical and mechanical services (For indoor & stationary setting).

### Applications:

Suitable for use on cable trays etc.

### Technical Data:

- SMACNA compliance - all products carry a 5:1 safety factor
- As per UL 1598, & 2239 CSA C22.2 No.250.0-08
- Tested & Certified by TUV Nord.

### Material Specification

Hook	Steel
Wire rope	Steel Galvanized
Ferrule	Aluminium

## Installation

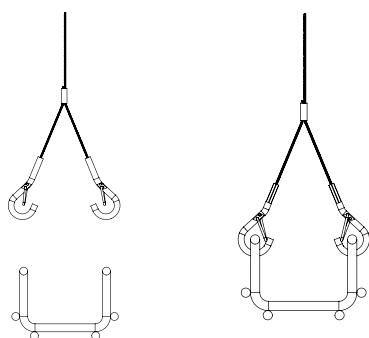

## Application

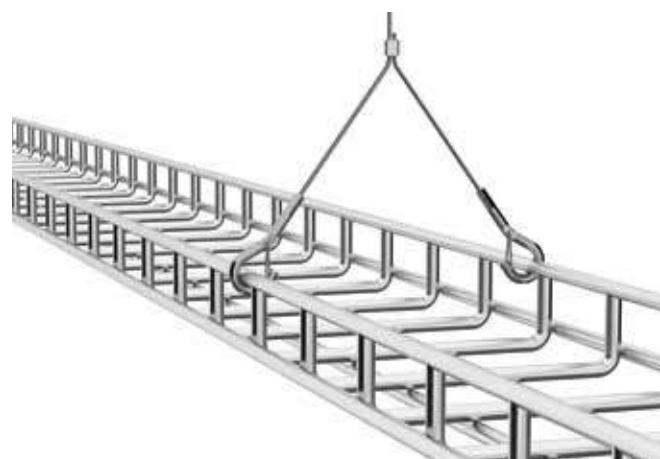

Wire Diameter	1.5 mm	2 mm	3.2 mm
Safety Factor	5:1	5:1	5:1
Safe Working Load (Kg)	Up to 30	Up to 56	Up to 113

**Note:** The correct gripper and wire rope combination should be used to ensure desired minimum safe working loads.

## EYE Bolt

Eyeloop wire rope crimped with M6, M8, M10 eyebolt



## Y-fit Eyebolt

Eyeloop wire rope crimped with M6, M8, M10 eyebolt



### Function:

Recommended for the suspension of HVAC, electrical and mechanical services

### Applications:

Suitable for concrete ceiling, metal decking and pressed metal brackets.

### Technical Data:

- SMACNA compliance - all products carry a 5:1 safety factor
- As per UL 1598, & 2239 CSA C22.2 No.250.0-08
- Tested & Certified by TUV Nord.

### Material Specification

<b>Eye Bolt</b>	Steel
<b>Wire rope</b>	Steel Galvaized
<b>Ferrul</b>	Aluminium

## Installation

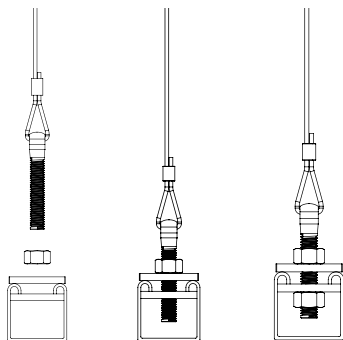

## Application



Thread	M6	M8	M8	M10
Wire Diameter	1.5 mm	2 mm	3.2 mm	5 mm
Safety Factor	5:1	5:1	5:1	5:1
Safe Working Load (Kg)	Up to 30	Up to 56	Up to 113	Up to 300

**Note:** The correct gripper and wire rope combination should be used to ensure desired minimum safe working loads.

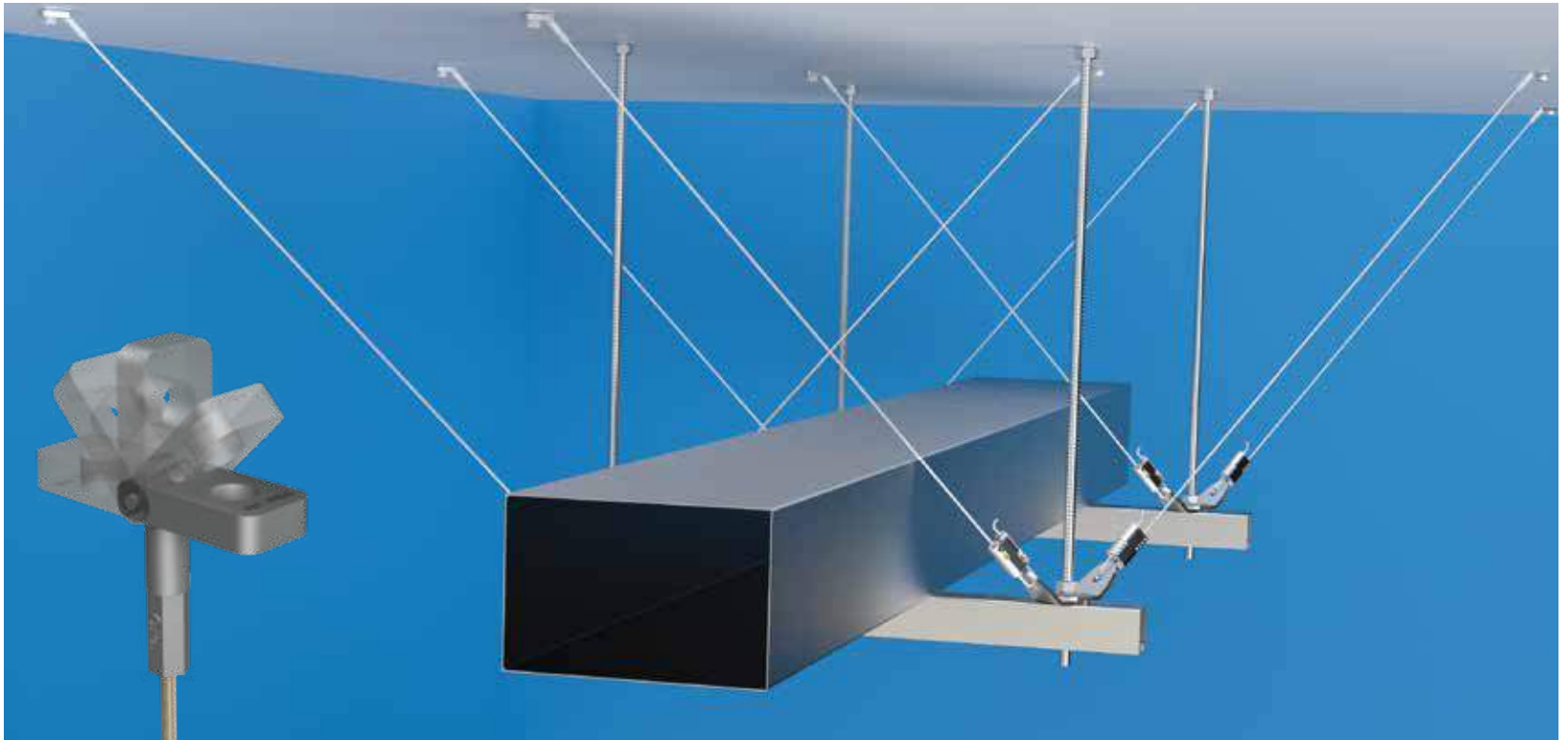

A swivel eyelet works in seismic bracing systems by providing a flexible and secure connection between the non-structural equipment and the structural equipment's. A seismic bracing system consists of cables that are attached to the equipment and the beams, or girders using swivel eyelets fittings and brackets. It allows the cable to rotate and adjust to the angle and direction of the seismic force.

#### Some features of swivel eyelet are:

- It has a high load capacity and can handle side loads up to 90 degrees.
- It is made of alloy steel or pre crimped wire and can be galvanized or plated to resist corrosion.
- It has a metric or UNC thread and can be easily installed or removed with the tool.
- It can be used with wire ropes, in different diameters/sizes.

#### DIFFERENT ANGLES FOR USAGES

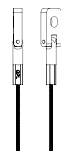

It can be use as straight

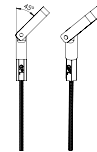

It can be use at 45°



It can be use at 90°

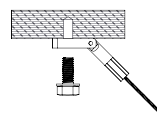

EYELET 45°, 90° & 180°  
PAT. PNDG

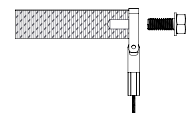
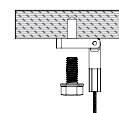

#### PRODUCT DETAILS

Description: - Swivel Eyelet  
Model: - GPA-148/148A/149/149A  
Material: - Steel  
Coating: - Zinc

Recommended wire with safe working load:-  
1.5mm - 30kg  
2.0mm - 56kg  
2.4mm - 70kg  
3.2mm - 113kg

## WIRE ROPE

Wire ropes are built up from individual wires. The most common are mild steel (Galvanized) and stainless steel.

A number of wires together form a strand, and several strands will be twisted together to form a rope.

Characteristics like fatigue resistance and resistance to abrasion are directly affected by the design of strands.



**GPWS** offers wire ropes in various thicknesses & in customized lengths.

- Customized wire rope spools can be supplied.
- Stainless steel wire rope spools can be supplied
- Remove prefix -GW and add prefix - SS in GPL code for stainless steel cables

S.No.	Material	GPL Code	Cross Section	Thickness			Length	
				Inch	cm	mm	Ft	Mtr
1	Galvanised	GW12300	7x7	3/64"	1.2	1000	300	
2	Galvanised	GW15300	7x7	1/16"	1.5	1000	300	
3	Galvanised	GW16300	7x7	1/16"	1.6	1000	300	
4	Galvanised	GW20300	7x7	5/64"	2.0	1000	300	
5	Galvanised	GW24150	7x7	3/32"	2.4	500	150	

### WIRE CROSS SECTION

7x7

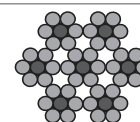

7x19

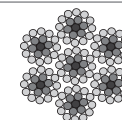

### Minimum working loads (MSWL)

- Mentioned loads are achieved using GPL gripper and GPL cable only.
- The 5:1 MSWL is tested and approved by TUV norrd Group on specific products.
- Loop gripper load is achieved when used vertically in a looped configuration
- Values in **BLUE** are in kilograms and values in **RED** are in pounds.

CABLE DIAMETER		SAFE WORKING LOAD ( KGS/LBS )	
		GAL VANISED CABLE	
MM	INCH FRACTION	LOOP GRIPPERS	SINGLE GRIPPERS
1.0	3/64"	11 / 24	10 / 22
1.2	3/64"	18 / 40	15 / 33
1.5	1/16"	30 / 66	25 / 55
1.6	1/16"	30 / 66	25 / 55
2.0	5/64"	56 / 123	45 / 99
2.4	3/32"	70 / 176	60 / 132
3.0	1/8"	100 / 220	90 / 198
3.2	1/8"	113 / 249	100 / 220
4.0	5/32"	220 / 485	140 / 308
4.8	3/16"	300 / 661	250 / 551
5.0	13/64"	300 / 661	250 / 551
6.0	15/64"	380 / 837	380 / 837
8.0	5/16"	480 / 1058	480 / 1058

**Note:** This is a standard load chart but different product combinations offer different safe working loads. Please speak to GPL expert for any clarification.

### Precautions

- To ensure hanging system integrity safety and load ratings use only GPL wire rope
- Do not use it for loads beyond the safe working range of the product.
- Do not pass plastic coated cable through the gripper.
- Do not apply any lubricant on any part of the assembly
- Do not use if cable or components are visibly distorted or worn
- Compliance with the local or National codes wherever applicable, is the buyer and/or installer's responsibility
- Do not use in chlorinated or caustic atmosphere, for dry location only



# GPL GLOBAL PRESENCE



ISO 9001:2015



**GOLDEN PEACOCK OVERSEAS LTD.**

Corporate Office : 20A, NSEZ Noida-201305, (U.P), India, Phone : 0120-4720201/04/05, [mktg@goldenpeakock.com](mailto:mktg@goldenpeakock.com)

[www.goldenpeakock.com](http://www.goldenpeakock.com)